

Be part of the vibe at

PARK LANE MALL

*The best of Spring Garden Road
under one roof*



Park Lane Mall
5657 Spring Garden Road
B3J 3R4

Park Lane is ideally situated on Spring Garden Road at the foot of The Halifax Citadel, just a block away from the famous Victorian Public Gardens and within a few blocks of universities, colleges, hospitals, and the downtown business core (which is home to approximately 50,000 employees). Park Lane offers a unique shopping experience, with a superb fashion mix and Cineplex entertainment complex with eight screens and stadium seating, amid marble, glass, and skylights.

TYPE	SUITE	SQ FT
Retail	195	718
Retail	199	678
Retail	201	439
Retail	2055	1,205
Retail	2155	697
Retail	3010	500
Retail	3100	3,323



Sherri Metcalfe, Commercial Leasing Specialist
902 830 0062 or email sherri@universalgroup.ca





PARK LANE

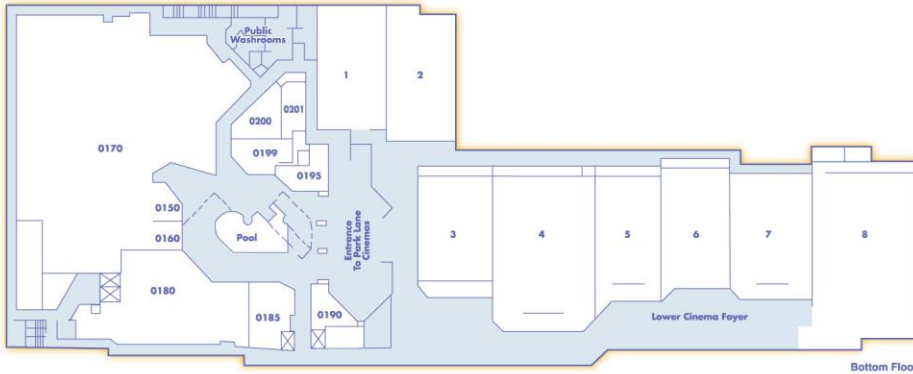

Bottom Floor



Main Floor

PARK LANE MALL Specifications

Size:

- 120,463 square feet on 2 retail floors

Climate Control:

- Fully air conditioned building
- Variable air volume system
- Ability to heat with natural gas or fuel oil

Elevators:

- Passenger and freight elevators
- Barrier-free controls
- Three escalators

Fire Safety:

- Two stage alarm system, with 24 hour monitoring
- Sprinkler system throughout complex
- Emergency Generator for emergency lighting, elevator, smoke evacuation system, stairwell pressurization and all life safety systems
- Smoke control with a positive smoke evacuation system through separate exhaust shaft

Security:

- Security room on-site
- 24-hour security patrols and emergency telephone to Crombie's security control room
- C.C.T.V. cameras throughout complex

Parking:

- Fully automated parkade parking system
- 433 – Vehicle parking

Loading Bay:

- 2 docking/loading ramps (Larger Delivery Vehicles)
- Parking available for smaller delivery vehicles
- 1 entrance/exit on Annandale Street

Accessibility:

- Pedway connection through Park Lane parkade to Park Lane Terraces

Amenities:

- Direct access to Spring Garden Road and Dresden Row
- Link to the Lord Nelson Hotel
- Food court, fitness centre and theatres all on-site



Sherri Metcalfe, Commercial Leasing Specialist
902 830 0062 or email sherri@universalgroup.ca

